

**D****Wichtige Pflegehinweise**

Bitte beachten Sie die wichtigen Pflegehinweise auf unserer Internetseite



www.held-hilft.de



Pflegehinweise

**PL****Ważne instrukcje dotyczące pielęgnacji**

Zwróć uwagę na ważną instrukcję dotyczącą pielęgnacji na naszej stronie internetowej



www.held-hilft.de



Pflegehinweise

**GB****Important care instructions**

Please note the important care instructions on our website



www.held-hilft.de



Pflegehinweise

**SK****Dôležité pokyny na starostlivosť**

Dbajte na dôležité pokyny týkajúce sa starostlivosti na našich webových stránkach



www.held-hilft.de



Pflegehinweise

**FR****Instructions d'entretien importantes**

S'il vous plaît noter les instructions de soins importants sur notre site Web



www.held-hilft.de



Pflegehinweise

**HU****Fontos kezelési utasítások**

Kérjük, vegye figyelembe a honlapunkon található fontos kezelési útmutatót



www.held-hilft.de



Pflegehinweise

**IT****Importanti istruzioni per la cura**

Si prega di notare le importanti istruzioni per la cura sul nostro sito web



www.held-hilft.de



Pflegehinweise

**RO****Instrucțiunile importante de îngrijire**

Rețineți instrucțiunile importante de îngrijire de pe site-ul nostru



www.held-hilft.de



Pflegehinweise

**NL****Belangrijke zorginstructies**

Let op de belangrijke zorginstructies op onze website



www.held-hilft.de



Pflegehinweise

**TR****Önemli bakım talimatları**

Lütfen web sitemizdeki önemli bakım talimatlarını dikkate alınız



www.held-hilft.de



Pflegehinweise

**CZ****Důležité pokyny pro péči**

Vezměte prosím na vědomí důležité pokyny pro péči na našich webových stránkách



www.held-hilft.de



Pflegehinweise

**RU****Важные инструкции по уходу**

Обратите внимание на важные инструкции по уходу на нашем веб-сайте



www.held-hilft.de



Pflegehinweise





Wir sind für Sie da!

Schnelle Hilfe 24/7
www.held-hilft.de

Ersatzteil-Sofort-Hilfe:
0571-7983810

22-10-2018

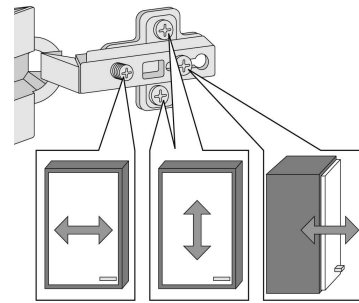
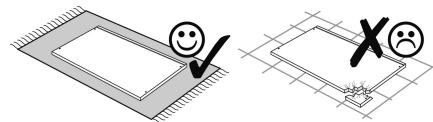

1 8 x 2802	2 8 x 2801	3 4 x 1503	4 4 x 1611	5 8 x 5 4 x 2855
6 5/5 x 16 16 x 2821	7 8 x 30 8 x 2861	8 5 x 25 8 x 2860	9 1 x 2863	10 5,8 x 55 2 x 2840
11 8 x 30 2 x 2842	12 2 x 2843	13 6 x 2865	14 3,5 x 15 8 x 2804	15 25 x 2862
16 6,3 x 11 4 x 2815	17 2 x 5254	18 4 x 9 2 x 2835	19 3 x 1055	20 4 x 22 6 x 2836
20 4 x 30 4 x 2812				

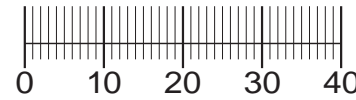

Das beigegefügte Wandbefestigungsmaterial (Dübel und Schrauben) eignet sich nur für festes Mauerwerk (z.B.: Beton- oder Ziegelwände). Für andere Wandaufbauten sind eventuell Spezialdübel und andere Schrauben notwendig. Ziehen Sie gegebenenfalls eine Fachkraft zu Rate.

De beigeleidende wandmontage hardware (pluggen en schroeven) is alleen geschikt voor massief metselwerk (bijvoorbeeld beton of bakstenen muren). Voor andere muur structuren zijn eventueel bijzondere ankerbouten en andere noodzakelijke. Draai indien nodig, een deskundige.

Приложенный материал для крепления к стене (дюбели и винты) пригоден только для жестких кладок (например, бетонные или кирпичные стены). Для других настенных конструкций необходимы смотря по обстоятельствам специальные дюбели и другие винты. При необходимости проконсультируйтесь у специалиста.

Le mur d'accompagnement matériel de montage (chevilles et les vis) ne convient que pour la maçonnerie solide (par exemple en béton ou des murs de briques). Pour les structures de mur d'autres sont peut-être spéciale boulons d'ancrage et d'autres nécessaires. Serrer le cas échéant, un expert.

Zalączony materiał do mocowania do ściany (kolki rozprężne i wkręty) nadaje się tylko do ścian murowanych (np. z betonu lub cegieł). Do ścian wykonanych w innych technologiach konieczne być mogą specjalne kolki rozprężne i inne wkręty. W razie potrzeby skorzystaj z fachowej pomocy.

Il muro di accompagnamento hardware di montaggio (tasselli e viti) è adatto solo per muratura piena (ad esempio calcestruzzo o muratura). Per le altre strutture murarie sono forse speciali bulloni di ancoraggio e necessari di altri. Serrare se necessario, un esperto.

The accompanying wall mounting hardware (anchors and screws) is suitable only for solid masonry (eg concrete or brick walls). For other wall structures are possibly special anchor bolts and other necessary. Tighten if necessary, an expert.

Ekteki duvara sabit montaj malzemeleri (dübel ve vidalar), sadece sağlam duvarlar için (örnek: beton veya tuğla) elverişlidir. Başka duvarlar için özel dübeller ve farklı vidalar gerekebilir. Gerektiğinde bir bilene danışınız.

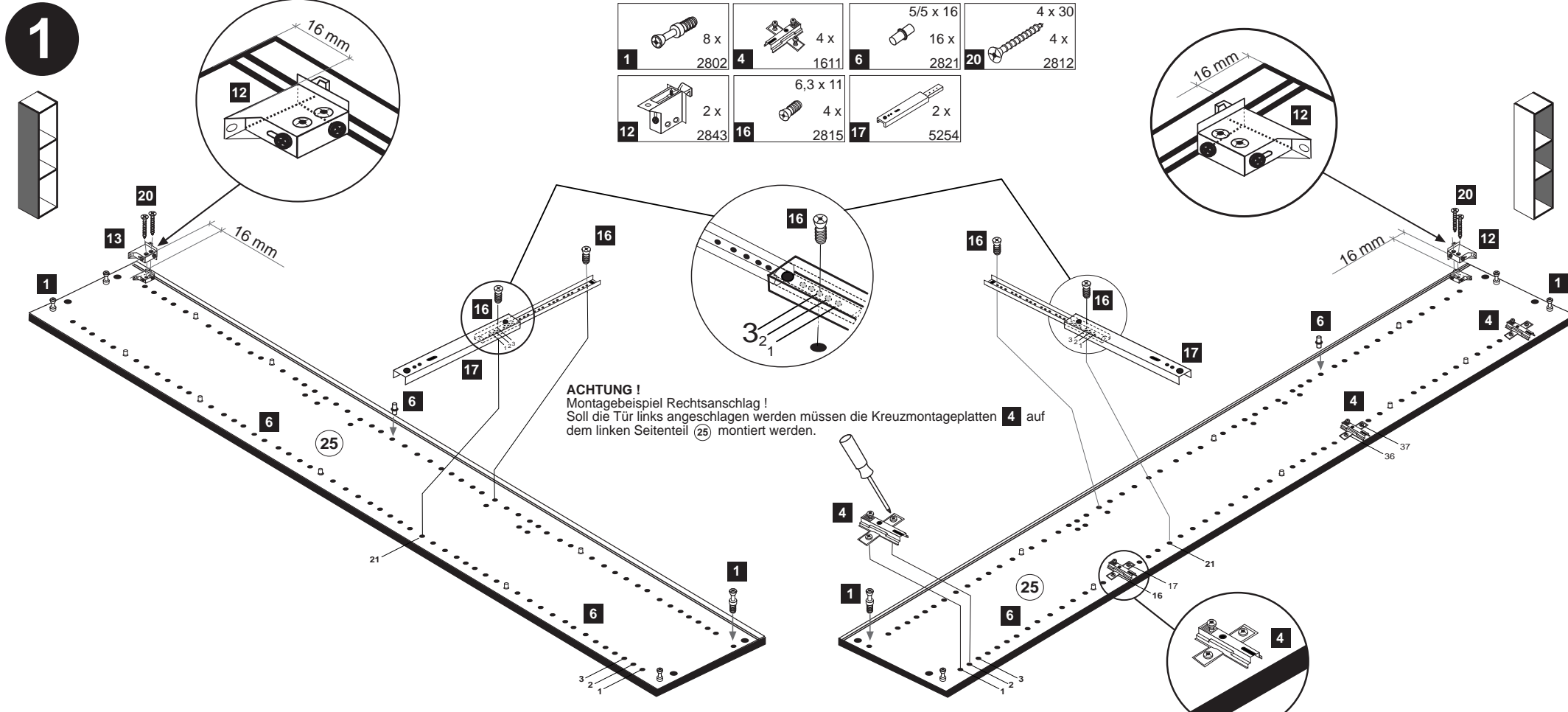
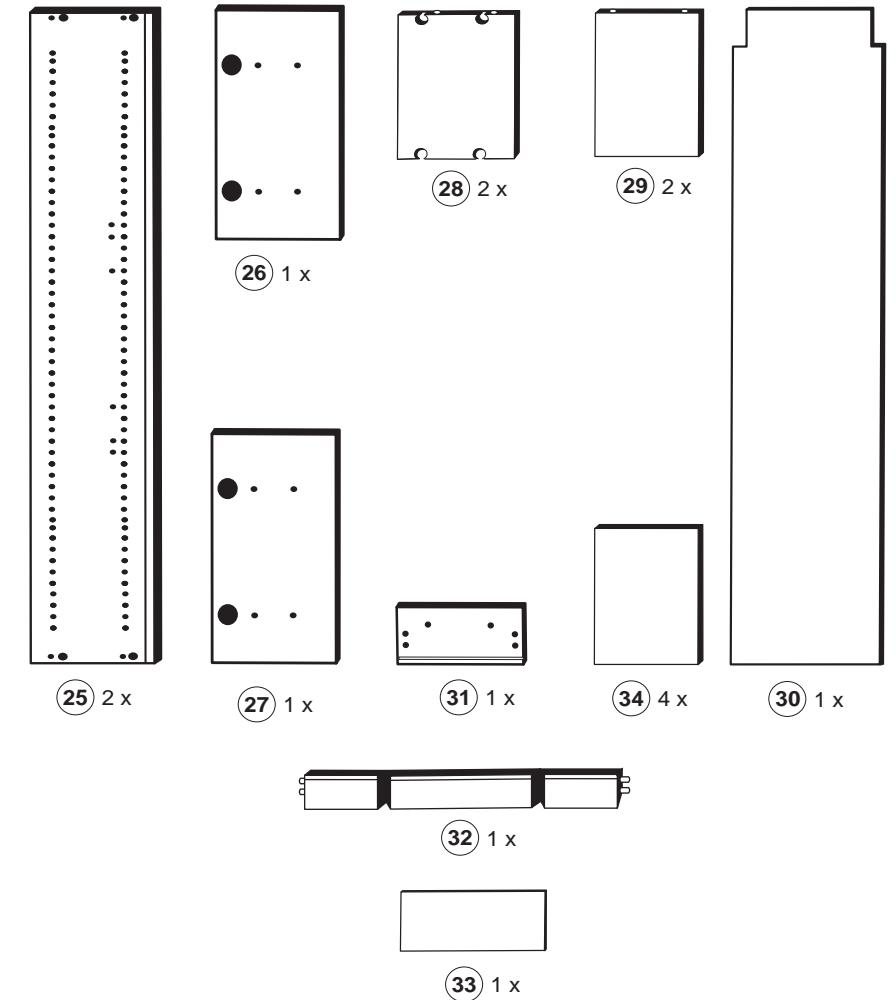

ACHTUNG!
Montagebeispiel Rechtsanschlag!
Soll die Tür links angeschlagen werden müssen die Kreuzmontageplatten 4 auf dem linken Seitenteil 25 montiert werden.

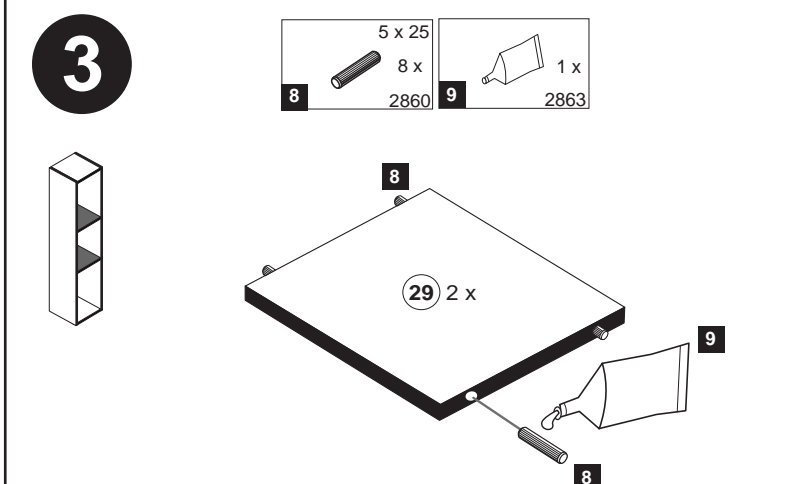
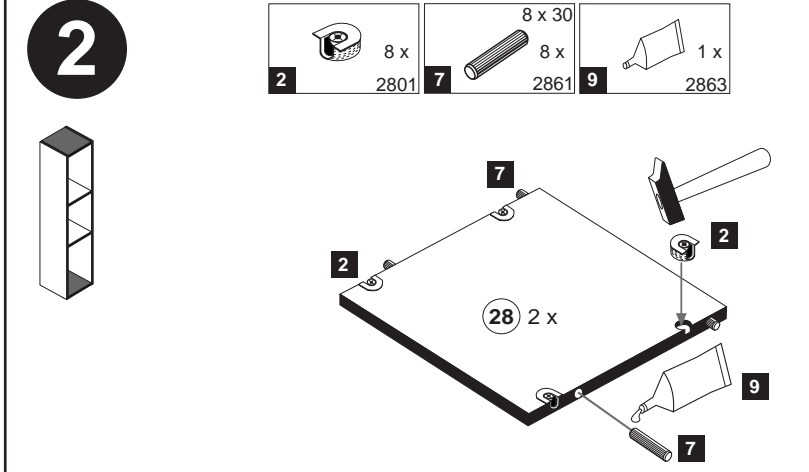

4

3	4 x 1503	13	4 x 2865	14	3,5 x 15 8 x 2804
----------	-------------	-----------	-------------	-----------	-------------------------

Step 4 shows the assembly of the base. Two side panels (1) are positioned vertically. Two base panels, 26 and 27, are placed horizontally. Brackets (3) are attached to the side panels and the base panels. Screws (14) are used to secure the brackets to the base panels. A 5 mm hole is indicated for the screws. A wooden block is shown being placed under the base panels.

6

15	25 x 2862
-----------	--------------

Step 6 shows the assembly of the top panel (30). The top panel is placed horizontally above the side panels (1). Brackets (15) are attached to the side panels and the top panel. A wooden block is shown being placed under the side panels.

5

9	1 x 2863
----------	-------------

D Leim
 GB Glue
 NL Lijm
 PL Klej
 TR Tutkal
 F Colle
 I Colla

20 min.

Step 5 shows the assembly of the side panels (25). The side panels are attached to the base (28) using glue (9) and screws (20). A wooden block is shown being placed under the base. A circular inset shows a close-up of the screw being inserted into the side panel.

7

9	1 x 2863	13	2 x 2865	19	2 x 1055	20	4 x 22 2 x 2836
----------	-------------	-----------	-------------	-----------	-------------	-----------	-----------------------

Step 7 shows the assembly of the shelves (31). The shelves are attached to the side panels (25) using brackets (19) and screws (20). A wooden block is shown being placed under the shelves. A circular inset shows a close-up of the shelf being attached to the side panel.

8

5	8 x 5 2 x	18	4 x 9 2 x 2835	19	2 x 1055	20	4 x 22 4 x 2836
----------	--------------	-----------	----------------------	-----------	-------------	-----------	-----------------------

Step 8 shows the assembly of the drawers (32). The drawers are attached to the side panels (25) using brackets (19) and screws (20). A wooden block is shown being placed under the drawers. A circular inset shows a close-up of the drawer being attached to the side panel.

9

10	5,8 x 55 2 x 2840	11	8 x 30 2 x 2842
-----------	-------------------------	-----------	-----------------------

Step 9 shows the assembly of the drawers (32). The drawers are attached to the side panels (25) using brackets (10) and screws (11). A wooden block is shown being placed under the drawers. A circular inset shows a close-up of the drawer being attached to the side panel.



1 4551

